



NEW

Light is strong

Discover the versatile and flexible lighting system OSRAM 24V TEC Flex

Let luminaires, organically formed structures, furniture and light covers come to life with the new TEC Flex product family from OSRAM. Easy luminaire integration and installation make TEC Flex the perfect choice for lighting professionals.

Light is OSRAM

OSRAM

Switch to TEC Flex now!

TEC Flex provides uniform illumination and saves energy with robust, durable LED strips

TEC Flex Generation 1 is the new portfolio of flexible, easy-to-install LED strips from OSRAM. Our wide range of TEC Flex products offers low energy consumption with an efficacy of up to 140lm/W as well as lower maintenance costs thanks to 50,000 hours of service life.

To complement your TEC Flex lighting installations, OSRAM offers dimmable and non-dimmable LED drivers as well as dimmers and other accessories. With simplified design-in and a five-year guarantee, TEC Flex is a complete system featuring a broad range of intelligent solutions to perfectly match the requirements of your individual lighting project.

Application areas

- Shopping malls
- Hotels
- Restaurants
- Residential buildings
- Light engine for luminaires
- Furniture-integrated lighting
- Installation in light coves
- Damp and outdoor installations

General lighting

Create seamless lines of light with no visible shadows thanks to the Shortpitch versions with 140 LEDs/m. Shape curves, lines or angles as desired and create unique applications in combination with other light points. Color consistency between IP and non-IP LED strips allows you to create continuous lines of light in dry as well as damp environments.

Ambient lighting

The Tunable White versions enable stepless dimming between 2700 K and 6500 K while maintaining a high color yield. This dynamic white light is perfect for highlighting architectural details and adapting the light to the time of day or seasonal changes, for example warm tones in fall and fresh shades in spring.

Effect lighting

Due to good color rendering, the TEC Flex RGB versions are able to create bright, powerful and realistic colors. Variable light colors are achieved by mixing together three basic color tones which generate different moods, capture the attention and surprise people with appealing, beautiful light.



LISYS Lighting Systems PLC

TEC Flex Shortpitch LED strips

Product name	GTIN (EAN)	K	Mac Adam	lm/m	V	W/m	lm/W	Ra	METER	Separability [mm]	Reel length [m]	IP
TF600S-G1-827	4062172133821	2700	3 SDCM	620	24	5.5	113	> 80	140	50	5	Non-IP
TF600S-G1-830	4062172133883	3000	3 SDCM	660	24	5.5	120	> 80	140	50	5	Non-IP
TF600S-G1-840	4062172133906	4000	3 SDCM	670	24	5.5	122	> 80	140	50	5	Non-IP
TF600S-G1-850	4062172133920	5000	3 SDCM	690	24	5.5	125	> 80	140	50	5	Non-IP
TF600S-G1-865	4062172133944	6500	3 SDCM	680	24	5.5	124	> 80	140	50	5	Non-IP
TF1000S-G1-827	4062172133968	2700	3 SDCM	1070	24	9	119	> 80	140	50	5	Non-IP
TF1000S-G1-830	4062172133982	3000	3 SDCM	1130	24	9	126	> 80	140	50	5	Non-IP
TF1000S-G1-840	4062172134002	4000	3 SDCM	1140	24	9	127	> 80	140	50	5	Non-IP
TF1000S-G1-850	4062172134026	5000	3 SDCM	1170	24	9	130	> 80	140	50	5	Non-IP
TF1000S-G1-865	4062172134040	6500	3 SDCM	1150	24	9	128	> 80	140	50	5	Non-IP
TF1500S-G1-827	4062172134064	2700	3 SDCM	1560	24	13.2	118	> 80	140	50	5	Non-IP
TF1500S-G1-830	4062172134088	3000	3 SDCM	1660	24	13.2	126	> 80	140	50	5	Non-IP
TF1500S-G1-840	4062172134101	4000	3 SDCM	1670	24	13.2	127	> 80	140	50	5	Non-IP
TF1500S-G1-850	4062172134125	5000	3 SDCM	1730	24	13.2	131	> 80	140	50	5	Non-IP
TF1500S-G1-865	4062172134149	6500	3 SDCM	1700	24	13.2	129	> 80	140	50	5	Non-IP
TF2000S-G1-827	4062172134163	2700	3 SDCM	1820	24	15.5	117	> 80	140	50	5	Non-IP
TF2000S-G1-830	4062172134187	3000	3 SDCM	1940	24	15.5	125	> 80	140	50	5	Non-IP
TF2000S-G1-840	4062172134200	4000	3 SDCM	1950	24	15.5	126	> 80	140	50	5	Non-IP
TF2000S-G1-850	4062172134224	5000	3 SDCM	2010	24	15.5	130	> 80	140	50	5	Non-IP
TF2000S-G1-865	4062172134248	6500	3 SDCM	2000	24	15.5	129	> 80	140	50	5	Non-IP
TFP600S-G1-827	4062172134279	2700	3 SDCM	600	24	5.5	109	> 80	140	50	5	IP66
TFP600S-G1-830	4062172134293	3000	3 SDCM	640	24	5.5	116	> 80	140	50	5	IP66
TFP600S-G1-840	4062172134316	4000	3 SDCM	640	24	5.5	116	> 80	140	50	5	IP66
TFP600S-G1-850	4062172134330	5000	3 SDCM	660	24	5.5	120	> 80	140	50	5	IP66
TFP600S-G1-865	4062172134354	6500	3 SDCM	650	24	5.5	118	> 80	140	50	5	IP66
TFP1000S-G1-827	4062172134378	2700	3 SDCM	1030	24	9	114	> 80	140	50	5	IP66
TFP1000S-G1-830	4062172134392	3000	3 SDCM	1110	24	9	123	> 80	140	50	5	IP66
TFP1000S-G1-840	4062172134415	4000	3 SDCM	1080	24	9	120	> 80	140	50	5	IP66
TFP1000S-G1-850	4062172134439	5000	3 SDCM	1130	24	9	126	> 80	140	50	5	IP66
TFP1000S-G1-865	4062172134453	6500	3 SDCM	1120	24	9	124	> 80	140	50	5	IP66
TFP1500S-G1-827	4062172134477	2700	3 SDCM	1530	24	13.2	116	> 80	140	50	5	IP66
TFP1500S-G1-830	4062172134491	3000	3 SDCM	1620	24	13.2	123	> 80	140	50	5	IP66
TFP1500S-G1-840	4062172134514	4000	3 SDCM	1630	24	13.2	123	> 80	140	50	5	IP66
TFP1500S-G1-850	4062172134538	5000	3 SDCM	1670	24	13.2	127	> 80	140	50	5	IP66
TFP1500S-G1-865	4062172134552	6500	3 SDCM	1660	24	13.2	126	> 80	140	50	5	IP66
TFP2000S-G1-827	4062172134576	2700	3 SDCM	1690	24	15.5	109	> 80	140	50	5	IP66
TFP2000S-G1-830	4062172134590	3000	3 SDCM	1910	24	15.5	123	> 80	140	50	5	IP66
TFP2000S-G1-840	4062172134613	4000	3 SDCM	1920	24	15.5	124	> 80	140	50	5	IP66
TFP2000S-G1-850	4062172134637	5000	3 SDCM	1960	24	15.5	126	> 80	140	50	5	IP66
TFP2000S-G1-865	4062172134651	6500	3 SDCM	1940	24	15.5	125	> 80	140	50	5	IP66

- Constant luminous flux over long distances due to state-of-the-art control technology
- Non-protected/Protected LED strips (IP00 and IP66)
- Small distances between the individual LEDs enable high lighting homogeneity
- Ready-to-install LED strips with 5 cm cut points ensure high levels of design freedom
- One bin only: 3-step MacAdam
- Robust structure

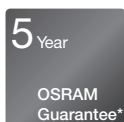

TEC Flex LED strips

Product name	GTIN (EAN)	K	Mac Adam	lm/m	V	W/m	lm/W	Ra	METER	Separability [mm]	Reel length [m]	IP
TF300-G1-827	4062172107020	2700	3 SDCM	350	24	2.8	125	> 80	70	100	5	Non-IP
TF300-G1-830	4062172107044	3000	3 SDCM	360	24	2.8	129	> 80	70	100	5	Non-IP
TF300-G1-840	4062172107068	4000	3 SDCM	370	24	2.8	132	> 80	70	100	5	Non-IP
TF300-G1-850	4062172107082	5000	3 SDCM	380	24	2.8	136	> 80	70	100	5	Non-IP
TF300-G1-865	4062172107105	6500	3 SDCM	370	24	2.8	132	> 80	70	100	5	Non-IP
TF1000-G1-827	4062172107129	2700	3 SDCM	1110	24	9.5	117	> 80	70	100	5	Non-IP
TF1000-G1-830	4062172107143	3000	3 SDCM	1200	24	9.5	126	> 80	70	100	5	Non-IP
TF1000-G1-840	4062172107167	4000	3 SDCM	1210	24	9.5	127	> 80	70	100	5	Non-IP
TF1000-G1-850	4062172107181	5000	3 SDCM	1240	24	9.5	131	> 80	70	100	5	Non-IP
TF1000-G1-865	4062172107204	6500	3 SDCM	1230	24	9.5	129	> 80	70	100	5	Non-IP
TF2000-G1-827	4062172107228	2700	3 SDCM	1830	24	15.5	118	> 80	70	100	5	Non-IP
TF2000-G1-830	4062172107242	3000	3 SDCM	2000	24	15.5	129	> 80	70	100	5	Non-IP
TF2000-G1-840	4062172107266	4000	3 SDCM	2060	24	15.5	133	> 80	70	100	5	Non-IP
TF2000-G1-850	4062172107280	5000	3 SDCM	2110	24	15.5	136	> 80	70	100	5	Non-IP
TF2000-G1-865	4062172107303	6500	3 SDCM	2060	24	15.5	133	> 80	70	100	5	Non-IP
TFP300-G1-827	4062172106627	2700	3 SDCM	340	24	2.8	121	> 80	70	100	5	IP66
TFP300-G1-830	4062172106641	3000	3 SDCM	350	24	2.8	125	> 80	70	100	5	IP66
TFP300-G1-840	4062172106665	4000	3 SDCM	360	24	2.8	129	> 80	70	100	5	IP66
TFP300-G1-850	4062172106689	5000	3 SDCM	370	24	2.8	132	> 80	70	100	5	IP66
TFP300-G1-865	4062172106702	6500	3 SDCM	360	24	2.8	129	> 80	70	100	5	IP66
TFP1000-G1-827	4062172106726	2700	3 SDCM	1080	24	9.5	114	> 80	70	100	5	IP66
TFP1000-G1-830	4062172106740	3000	3 SDCM	1160	24	9.5	122	> 80	70	100	5	IP66
TFP1000-G1-840	4062172106764	4000	3 SDCM	1170	24	9.5	123	> 80	70	100	5	IP66
TFP1000-G1-850	4062172106788	5000	3 SDCM	1190	24	9.5	125	> 80	70	100	5	IP66
TFP1000-G1-865	4062172106801	6500	3 SDCM	1180	24	9.5	124	> 80	70	100	5	IP66
TFP2000-G1-827	4062172106825	2700	3 SDCM	1740	24	15.5	112	> 80	70	100	5	IP66
TFP2000-G1-830	4062172106849	3000	3 SDCM	1940	24	15.5	125	> 80	70	100	5	IP66
TFP2000-G1-840	4062172106863	4000	3 SDCM	2010	24	15.5	130	> 80	70	100	5	IP66
TFP2000-G1-850	4062172106887	5000	3 SDCM	2040	24	15.5	132	> 80	70	100	5	IP66
TFP2000-G1-865	4062172106900	6500	3 SDCM	2010	24	15.5	130	> 80	70	100	5	IP66

- Constant luminous flux over long distances due to state-of-the-art control technology
- Non-protected/Protected LED strips (IP00 and IP66)
- High efficiency of up to 140lm/W enables energy savings also in general illumination
- Ready-to-install LED strips
- One bin only: 3-step MacAdam
- Robust structure

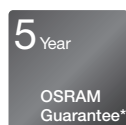

*For conditions and details, go to www.osram.com/system-guarantee

TEC Flex RGB and TW LED strips

Product name	GTIN (EAN)	K	Mac Adam	lm/m	V	w/m	lm/W	Ra	METER	Separability [mm]	Reel length [m]	IP
TF400RGB-G1	4062172154284	R, G, B	-	400	24	11	36	-	50	100	5	Non-IP
TFP400RGB-G1	4062172155069	R, G, B	-	360	24	11	33	-	50	100	5	IP66
TF2000TW-G1-827.865	4062172154246	2700-6500	3 SDCM	1940	24	13.5	144	>80	140	100	5	Non-IP
TFP2000TW-G1-827.865	4062172154260	2700-6500	3 SDCM	1820	24	13.5	135	>80	140	100	5	IP66

Note: Data are preliminary and may change without notice. For updated values, please check the technical datasheet.

- TEC Flex Tunable White for continuous modulation of the color temperature from 2700 K to 6500 K
- TEC Flex RGB versions for the variation of light colors
- Robust structure
- Realistic colors thanks to good color rendering
- Non-protected/Protected LED strips (IP00 and IP66)
- Ready-to-install LED strips
- Dynamic lighting installations

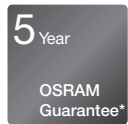

*For conditions and details, go to www.osram.com/system-guarantee

RGB

2700-6500

Packaging

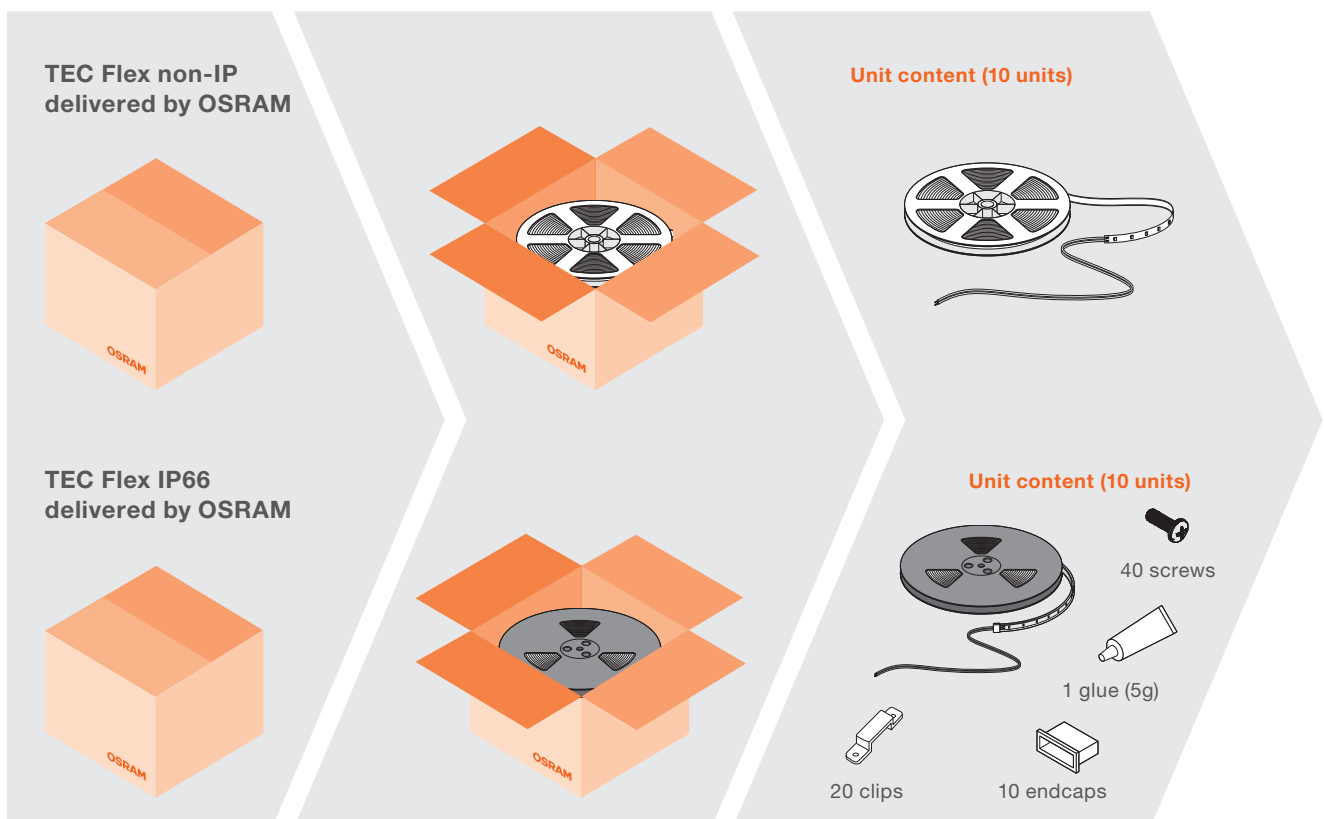

The perfect 24V OSRAM system for flexible lighting

Matching LED drivers

Application area	Product name	GTIN (EAN)	Dimmable
Indoor	OTi DALI 50/220-240/24 1-4 CH	4052899452916	DALI-2
	OTi DALI 80/220-240/24 1-4 CH	4052899452893	DALI-2
	OTi DALI 160/220-240/24 1-2 CH	4052899986305	DALI-2
	OTi DALI 50/220-240/24 TW	4052899490772	DALI DT8
	OTi DALI 80/220-240/24 TW	4052899490758	DALI DT8
	OTi DALI 160/220-240/24 TW	4052899986312	DALI DT8
	OT BLE 80/220-240/24 1-4 CH	4062172046568	BLE
	OT 20/220-240/24	4050300618111	No
	OT BLE DIM 12-24	4052899557833	BLE
	OT DMX RGBW DIM 12-24	4052899557949	DMX
	OTi DALI DIM	4008321061195	DALI
	OT DIM	4050300943459	1-10 V
	OT SLIM 30/220-240/24	4062172135733	No
	OT SLIM 60/220-240/24	4062172135856	No
	OT SLIM 160/220-240/24	4062172135894	No
	OT SLIM 100/220-240/24	4062172135917	No
	OT SLIM 250/220-240/24	4062172135870	No
	ELEMENT 30/220-240/24 G2	4052899605503	No
	ELEMENT 60/220-240/24 G2	4052899605527	No
	ELEMENT 120/220-240/24 G2	4052899605541	No
ELEMENT 180/220-240/24 G2	4052899605565	No	
Outdoor	OTi DALI 100/220-240/24 1-4 CH	4062172119191	DALI-2
	OTi DALI 210/220-240/24 1-4 CH	4062172032087	DALI-2
	OT 20/220-240/24 DIM P	4052899545809	1-10 V
	OT 40/220-240/24 DIM P	4052899545823	1-10 V
	OT 60/220-240/24 DIM P	4052899545847	1-10 V
	OT 100/220-240/24 DIM P	4052899545861	1-10 V
	OT 130/220-240/24 DIM P	4052899545885	1-10 V
	OT 250/220-240/24 DIM P	4052899545908	1-10 V
	OT 20/220-240/24 P	4052899545922	No
	OT 40/220-240/24 P	4052899545946	No
	OT 60/220-240/24 P	4052899545960	No
	OT 100/220-240/24 P	4052899545984	No
	OT 130/220-240/24 P	4052899546004	No
	OT 250/220-240/24 P	4052899546028	No

Optional connection system



Product name	Description	GTIN (EAN)	MOQ
FX-SC08-G2-CT2PF-0500	2-pin connector 0.5m cable	4052899464735	20
FX-SC08-G2-CT2PF-1000	2-pin connector 1m cable	4052899464766	20
FX-SC08-G2-CT4PJ	Jumper (strip-to-strip connector)	4052899464858	25
FX-SC08-G1-FW4P-LIN-0030	Extension wire 30 mm	4008321875587	100
FX-SC08-G1-FW4P-LIN-0150	Extension wire 150 mm	4008321875563	50
FX-SC08-G1-FW4P-LIN-0300	Extension wire 300 mm	4052899469259	50
FX-SC08-G2-C2PF-IP54-0500	2-pin connector IP54 0.5m cable	4052899464889	20
FX-SC08-G2-BTJ-IP54	Silicon boot	4052899568853	25
FX-SC08-G2-CT4PF-0500	IP00 4-pin connector 0.5m cable	4052899464797	20
FX-SC08-G2-CT4PF-1000	IP00 4-pin connector 1m cable	4052899464827	20
FX-SC08-G2-CT3PF-0500HF	IP00 3 pin connector 0.5m cable	4052899482999	20
FX-SC08-G2-CT3PFE-0500HF	IP00 3-pin connector 1m cable	4052899483026	20

Profile system at a glance

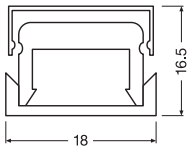

W 14.7 x H 9.7 x L 2100 mm

LF-LTS-2100

4008321978981

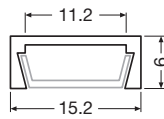

W 15.2 x H 6 x L 3000 mm

FX-QMS-G1-TU15H6-300

4052899448865

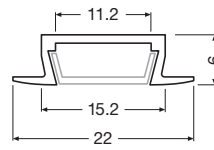

W 22 x H 6 x L 3000 mm

FX-QMS-G1-TU15H6W3-300

4052899448889

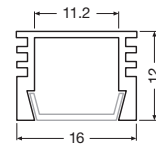

W 16 x H 12 x L 3000 mm

FX-QMS-G1-TU16H12-300

4052899448964

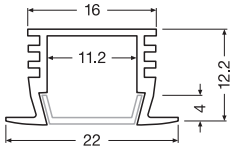

W 22 x H 12 x L 2000 mm

FX-QMS-G1-TU16H12W3-300

4052899448988

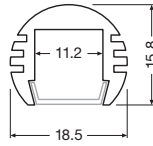

W 18.5 x H 15.8 x L 3000 mm

FX-QMS-G1-TR19H16-300

4052899449008

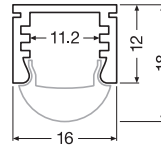

W 16 x H 12 x L 3000 mm

FX-QMS-G1-TU16H12LS-300

4052899449046

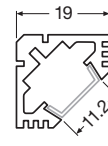

W 16 x H 12 x L 3000 mm

FX-QMS-G1-TU16H12LS-300

4052899448867

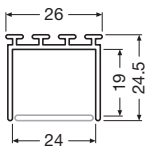

W 26 x H 24.5 x L 3000 mm

FX-QMW-G1-TU26H25-300

4052899448803

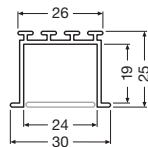

W 30 x H 25 x L 3000 mm

FX-QMW-G1-TU26H25W2-300

4052899448841

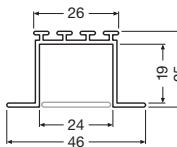

W 46 x H 25 x L 3000 mm

FX-QMW-G1-TU26H25W10-300

4052899448773

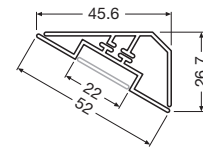

W 45.6 x H 26.7 x L 3000 mm

FX-QMW-G1-TK30D46H27-300

4052899448827

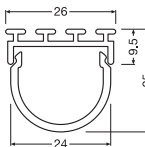

W 26 x H 9.5 x L 3000 mm

FX-QMW-G1-TU26H10-300

4062172114165

Innovative products and comprehensive support – that's OSRAM!

Are you looking for a reliable and globally experienced partner who can offer you a wide range of durable and energy-efficient LED products? OSRAM is that partner. For well over 100 years, we have been developing the lighting innovations and brands that you need to complete your projects quickly, flexibly, cost-efficiently and successfully. And we support you with well thought-out LED system solutions so that your lighting planning can be perfectly adapted to the most diverse project requirements. Get in touch with us!

**OSRAM Germany
and Austria**
Phone: +49 89 6213-0
E-mail: contact@osram.com

**OSRAM Benelux B.V.
Netherlands**
Phone: +31 (0) 88 750 8800
E-mail: osram@osram.nl

Belgium
Phone: +32 (0) 2 588 49 51
E-mail: osram@osram.be

OSRAM Sales EOOD Bulgaria
Phone: +359 32 348 110
E-mail: sales-sofia@osram.com

OSRAM d.o.o. Croatia
Phone: +385 1 3032-023
E-mail: osram@osram.hr

**OSRAM Ceska republika s.r.o.
Czech Republic**
Phone: +42 0 554 793 111
E-mail: osram@osram.cz

OSRAM A/S Denmark
Phone: +45 43 30 20 40

OSRAM Oy Finland
Phone: +358 9 8493 2200
E-mail: asiakaspalvelu@osram.fi

**Baltic DS/OSRAM Oy Finland:
Estonia, Latvia and Lithuania**
Phone: +358 9 8493 2200
E-mail: customerservice@osram.fi

**OSRAM Lighting Middle East FZE
Dubai – United Arab Emirates**
Phone: +971 4 523 1777
E-mail: ds-mea@osram.com

OSRAM Lighting SASU France
Phone: +33 3 68 41 89 33
E-mail: oem@osram.fr

OSRAM Limited Great Britain
Phone: +44 1925 273 360
E-mail: oem@osram.com

**OSRAM a.s. Magyarországi
Fióktelepe Hungary**
Phone: +36 1 225 30 55
E-mail: info@osram.hu

**OSRAM SpA Società Riunite
OSRAM Edison Clerici Italy**
Phone: +39 02 424 91
E-mail: oemcentroservizi@osram.com

OSRAM Lighting AS Norway
Phone: +47 40 00 40 14

OSRAM North Africa S.a.r.l.
E-mail: contact@osram.com

OSRAM (Pty.) Ltd. South Africa
Phone: +27 10 221 40 00

OSRAM Sp. z.o.o. Poland
Phone: +48 22 376 57 00
E-mail: biuro.pl@osram.pl

**OSRAM LDA
Portugal, Açores, Madeira**
Phone: +351 21 033 22 10
E-mail: osram@osram.pt

OSRAM OOO Russia DS
Phone: +7 (499) 649-7070
E-mail: ds-russia@osram.com

OSRAM Romania S.R.L.
Phone: +40 (21) 232 85 61
E-mail: osram_ro@osram.com

OSRAM, a.s. Slovak Republic
Phone: +421 35 64 64 473
E-mail: contact@osram.com

OSRAM a.s. Slovenia
Phone: +43 1 250 24
E-mail: info@osram.at

OSRAM Lighting S.L. Spain
Phone: +34 91 491 52 17
E-mail: marketing-ds@osram.com

OSRAM AB Sweden
Phone: +46 128 70 400
E-mail: info@osram.se

OSRAM Lighting AG Switzerland
Phone: +41 52 555 25 55
E-mail: info.ch@osram.com

**OSRAM Teknolojileri Ticaret A.S.
Turkey**
Phone: +90 212 703 43 00
E-mail: contact@osram.com

OSRAM Sales Greece
Phone: +30 21 309 940 36
E-mail: greece@osram.com

OSRAM GmbH

Headquarters Germany:

Marcel-Breuer-Strasse 6
80807 Munich, Germany
Phone +49 89 6213-0
Fax +49 89 6213-2020
www.osram.com

OSRAM